

Ducted Dehumidification Systems FD-S Series

Dehumidifiers Australia

8 February 2021

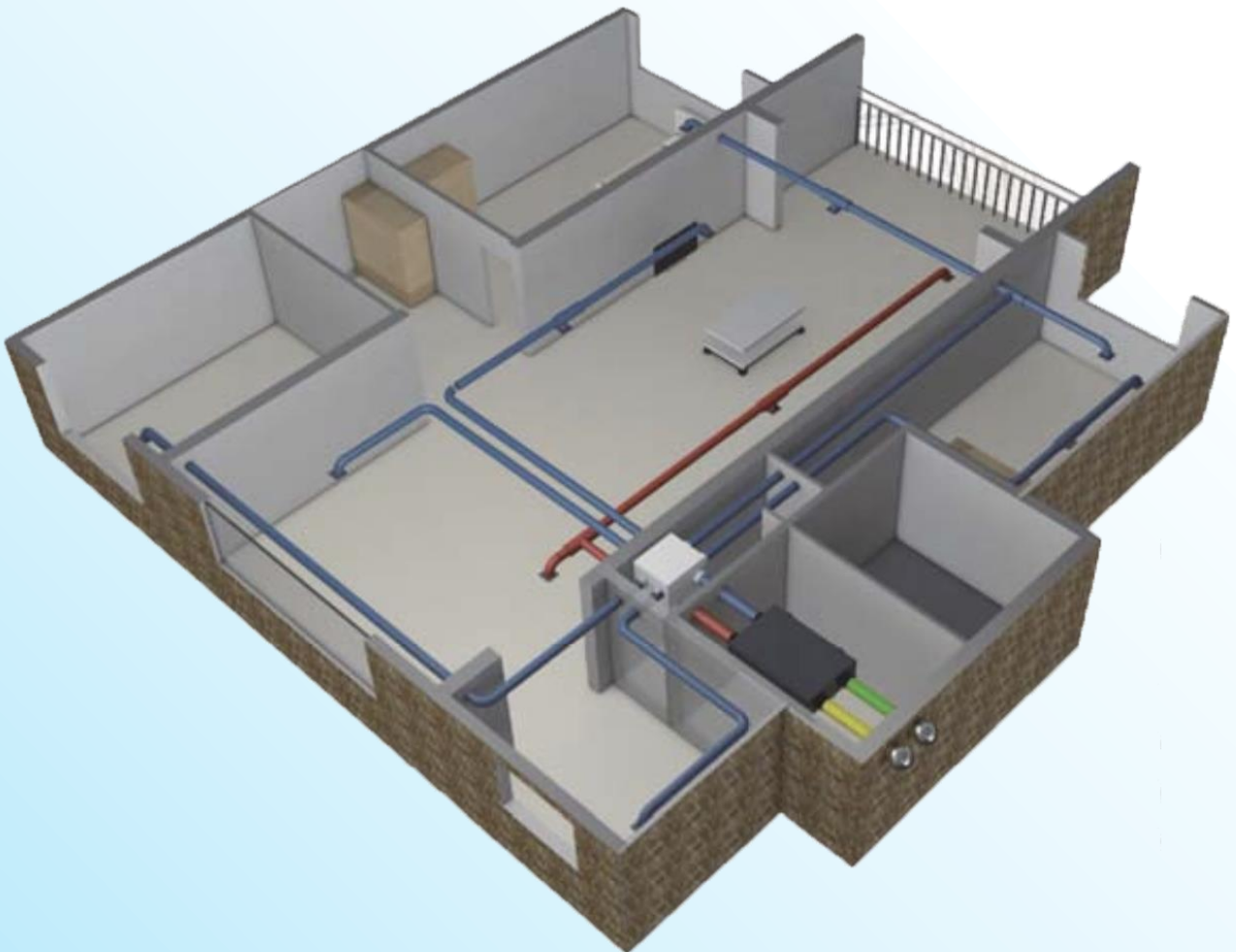

FD-S Series Ducted Dehumidifiers with Single Air Flow

Description

FD-S Series is the single airflow type. FD-S Series are good in a wide range of applications such as residential dehumidification, installation parallel with a HVAC system, or in small pools, green houses, office areas, gyms, etc.

The air will pass through the refrigeration coil to remove excess moisture and prevent the forming of mold and mildew. Condensation will be collected in the stainless-steel drain pan and can be pushed out automatically with positive air pressure.

The FD-S dehumidifiers can double as an air purification system with a UV Lamp for killing bacteria and virus. Three stage filtrations (G4, F7, H13 HEPA) can prevent mold, mildew, dust and allergen particles down to 0.3 μ m, leading to a better smelling home without musty odors and better health.

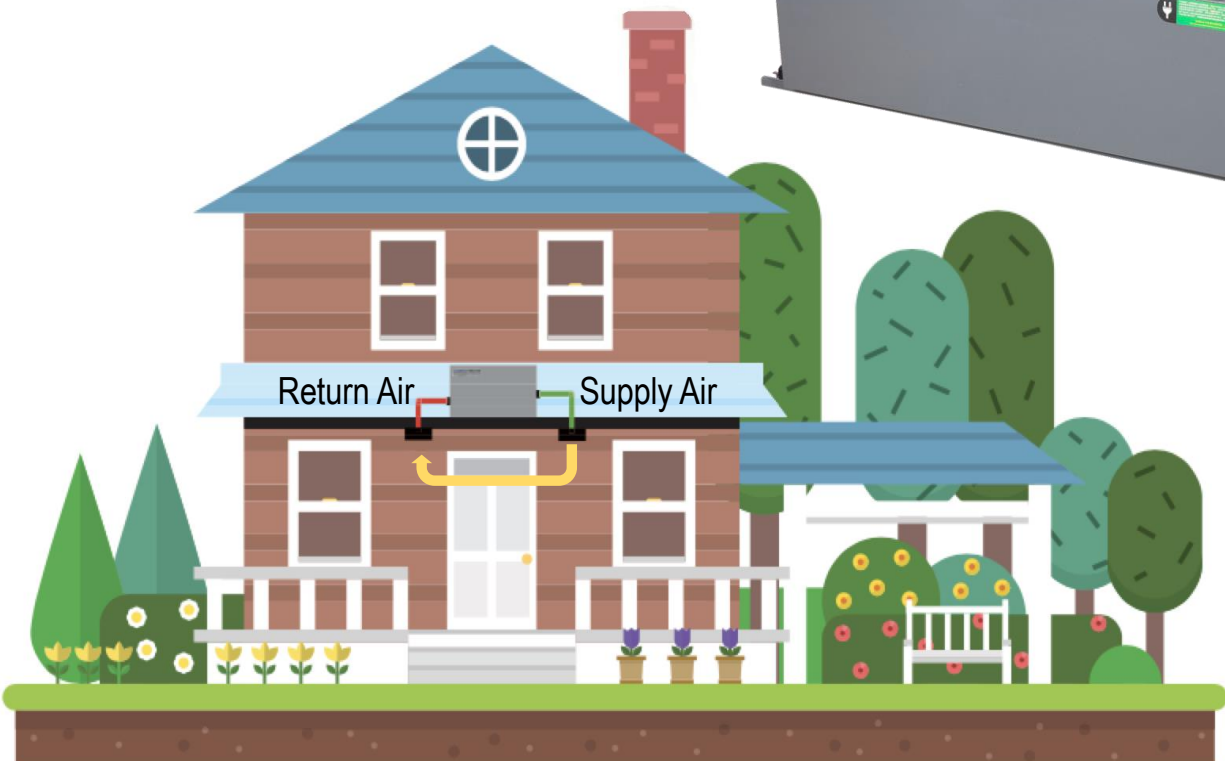

FD-S Series Ducted Dehumidifiers with Single Air Flow

Key Features

- ❑ **Single Air Flow Design**
- ❑ **Positive Pressure Drainage, no need for a water trap**
- ❑ **HEPA, UV Sterilization Lamp, Anion Generator**
 - ✓ 3 Stage Filtration with G4, F7, H13 (HEPA) and Anion Generator to provide clean air, free of dust and allergens
 - ✓ The UV Lamp provide sterilization to kill bacteria and viruses
- ❑ **EC Fan Motor**
 - ✓ EC Fan Motor allows for variable speed and quieter operation than other motor types
 - ✓ Power consumption is lower, increasing the efficiency of the dehumidifier
 - ✓ Precise control of fan speed to match your existing system or air flow requirements
- ❑ **Advanced Wall Controller**
 - ✓ The humidity sensor built into the controller gives the machine an accurate reading of indoor humidity
 - ✓ Built in RS485 interface can be used with BMS systems
 - ✓ Wi-Fi control through iOS/Android App
- ❑ **No PCB design, 100% controlled by the controller**
 - ✓ Easy and simple maintenance without PCB
 - ✓ Highly reliable and mature components are to maximize system stability and up time

Single Air Flow Working Principle

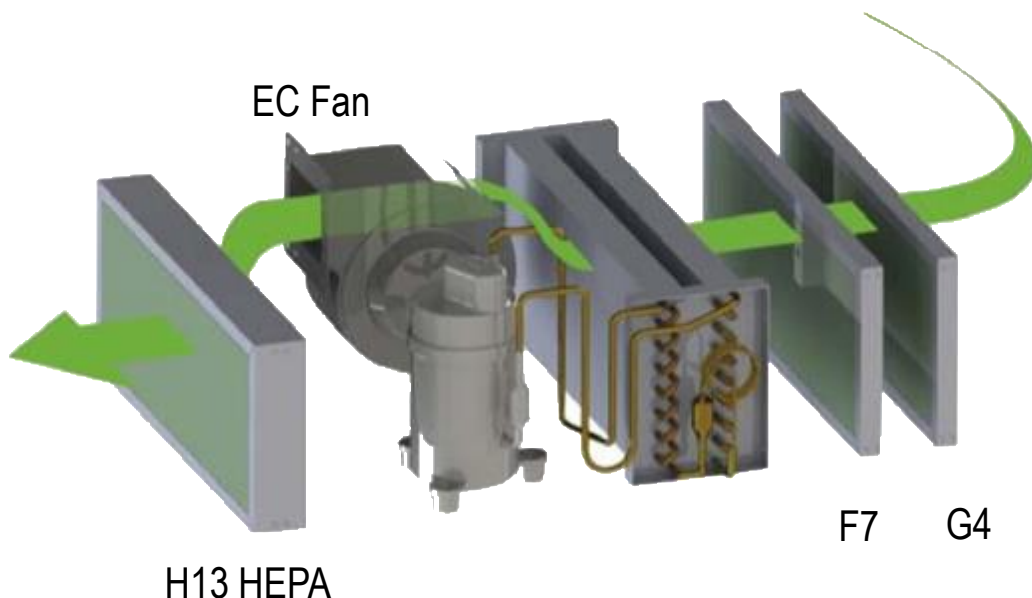

FD-S Series Ducted Dehumidifiers with Single Air Flow



Specifications

FD-S Series	FD-S28L	FD-S40L	FD-S60L	FD-S100L	FD-S140L
Capacity(30°C,80%RH)	28L/D	40L/D	60L/D	100L/D	140L/D
Supply air flow(m3/h)	280-350	500-670	650-780	1000-1200	1200-1350
Fan speed	2-speed/Variable Speed				
Static pressure	100 Pa				
Return air flow(m3/h)	280-350	500-670	650-780	1000-1200	1200-1350
Power	400W	620 W	700 W	920 W	1160 W
Current	1.8A	2.8A	3.3A	4.3A	5.4A
Voltage	220V/50Hz				
Control	Touch Screen LCD Controller				
Noise level	<35DB	<45DB	<45DB	<45DB	<45DB
Compressor	Embraco	Embraco	Embraco	Panasonic	Panasonic
Refrigerant	R134A	R134A	R134A	R410A	R410A
Condenser	Copper Tubes with Blue Hydrophilic-coated Aluminium Fins				
Drain pan	SUS304				
Drain hole size	DN20				
Filter	G4(+F7+H13)				
Purification	UV Air Sanitizer + Anion Generator				
Return air duct	Φ100 mm	Φ150 mm	Φ150 mm	Φ200 mm	Φ200 mm
Supply air duct	Φ100 mm	Φ150 mm	Φ150 mm	Φ200 mm	Φ200 mm
Body size	830*433*285 mm	950*539*265 mm	950*539*265 mm	1030*639*375 mm	1030*639*375 mm
Net weight	40kg	45kg	47kg	68kg	71kg